



## GLOUCESTER PLACE

MARYLEBONE, NW1

£3,445 PER MONTH

\*OPPOSITE THE LONDON BUSINESS SCHOOL\* Centrally located on Gloucester Place is this generously sized 2 bedroom apartment in Radley House, a purpose built block with caretaker. The property comprises of a reception room, fully fitted kitchen, 2 double bedrooms and a bathroom suite.

Gloucester Place is ideally situated within a 5 minute walk of Baker Street amenities and transport links. Viewings are highly recommended.

**PMP** | INTERNATIONAL

# Radley House, NW1 6DP

Approx. Gross Internal Area = 64.8 sq m / 697 sq ft

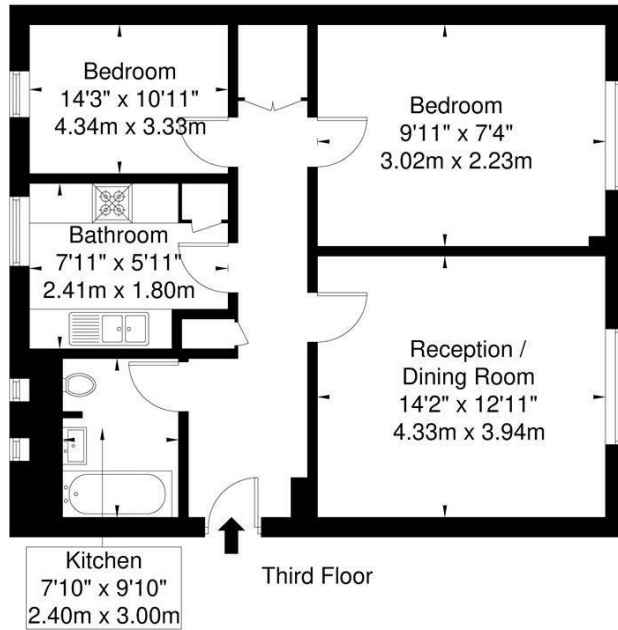

Ref \_\_\_\_\_ Copyright THEBLÉUPLAN  
 Disclaimer : Floor plan measurements are approximate and are for illustrative purposes only. While we do not doubt the floor plan accuracy and completeness, you or your advisors should conduct a careful, independent investigation of the property in respect of monetary valuation.



Energy Efficiency Rating		Current	Potential
Very energy efficient - lower running costs			
(92 plus) A			
(81-91) B			
(69-80) C		77	82
(55-68) D			
(39-54) E			
(21-38) F			
(1-20) G			
Not energy efficient - higher running costs			
England & Wales		EU Directive 2002/91/EC	

Agents Note: Whilst every care has been taken to prepare these particulars, they are for guidance purposes only. All measurements are approximate and are for general guidance purposes only and whilst every care has been taken to ensure their accuracy, they should not be relied upon and potential buyers/tenants are advised to recheck the measurements

London  
 PMP International  
 94 Belsize Lane  
 Belsize Park  
 London  
 NW3 5BE

020 7701 2878  
 info@pmpi.co.uk  
 www.pmpi.co.uk

**PMP** | INTERNATIONAL